

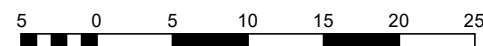

Notes:

- Do not scale from this drawing. Use figured dimensions in all cases.
- Verify dimensions on site and report any discrepancies to the Architect immediately.
- This drawing is to be read in conjunction with the Architect's Specification
- © This drawing is copyright and may only be reproduced with the Architect's permission.

Drawing Notes:

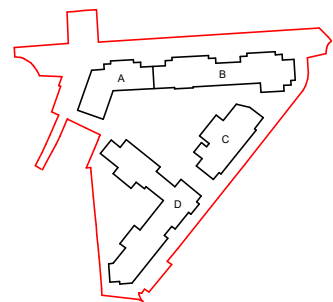

- Red Line Areas**
- SITE BOUNDARY WITHIN SDCC ADMINISTRATIVE AREA
 - ROAD WORKS WITHIN DCC ADMINISTRATIVE AREA SUBJECT TO SEPARATE PLANNING APPLICATION
-
- Studio Bed
 - 1 Bed
 - 2 Bed
 - 3 Bed
 - Residents Amenity
 - Commercial
 - Creche
 - Library
 - Community Cafe
 - Ancillary
 - DAC Parking
 - E-Charging Parking
 - Creche Staff Parking
 - Cargo Bicycle
 - Street Parking
 - Loading Bay

Red Line Areas			
	Name	Area m2	Area Ha.
	Planning Red Line	19,120.8 m²	1.91 hectare

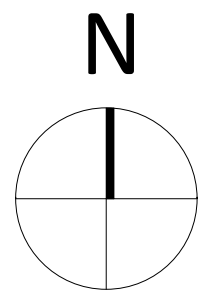

P3-S-01	28/02/2025	NF	For Planning LRD Stage 3
P3-S-00	12/09/2024	NF	For Planning LRD Stage 2
Rev.	Date	Drwn	Details of Issue / Revision

Issues & Revisions



Dartry Mills,
Dartry Road
Dublin 6,
D06 Y0E3
T: +353 (0)1 498 7000
W: www.reddyarchitecture.com
E: info@reddyarchitecture.com

Client Details:
Watfore Ltd. (Dairygold)

Project Details:
Parkmore
Long Mile Road, Dublin

Drawing Title:
Site Plan, Planning Permission, Ground Floor

Job No.		Sheet Size:		Scale @A1:	
P18-199D		A1 Landscape		1:500	
Issue Date:		Drawn By:		Reviewed By:	
28/02/25		NF		DMcD	
Status	Purpose of Issue				
P3	For Planning				
Project - System - Spatial Zone - Level - Type - Originator - Role - Number					Revision
LMR-02-SW-ZZ-DR-RAU-AR-2004					P3-S-01