

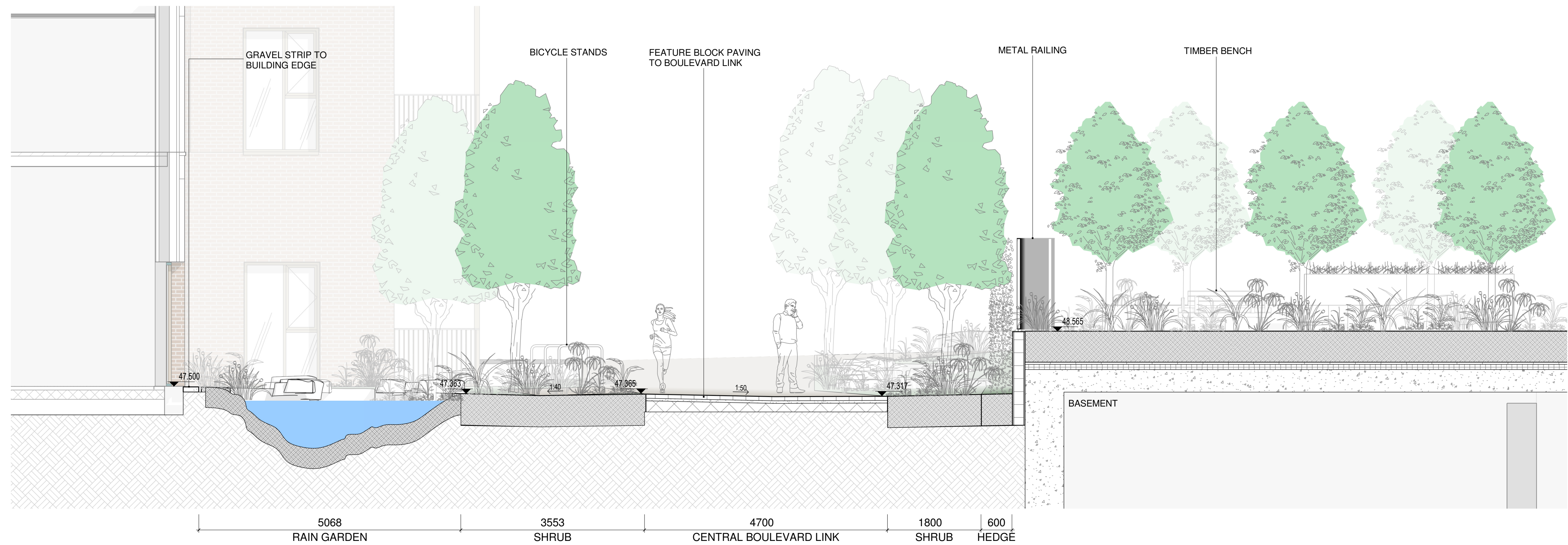

9 SECTION 09  
SCALE: 1:50 @A1



10 SECTION 10  
SCALE: 1:50 @A1

NOTE  
ALL DIMENSIONS TO BE CHECKED ON SITE  
THIS DRAWING IS TO BE READ IN CONJUNCTION WITH  
RELEVANT CONSULTANTS DRAWINGS  
NO PART OF THIS DOCUMENT MAY BE REPRODUCED OR  
TRANSMITTED IN ANY FORM OR STORED IN ANY RETRIEVAL  
SYSTEM OF ANY NATURE WITHOUT THE WRITTEN PERMISSION  
OF THE LANDSCAPE ARCHITECT AS COPYRIGHT HOLDER EXCEPT  
AS AGREED FOR USE ON THE PROJECT FOR WHICH THE  
DOCUMENT WAS ORIGINALLY ISSUED.  
FOR DRAWING INDEX, GENERAL NOTES, REFER TO  
DWG L1-001

CLIENT: Watfore Ltd (Dairygold)

ARCHITECTS: Reddy Architecture + Urbanism

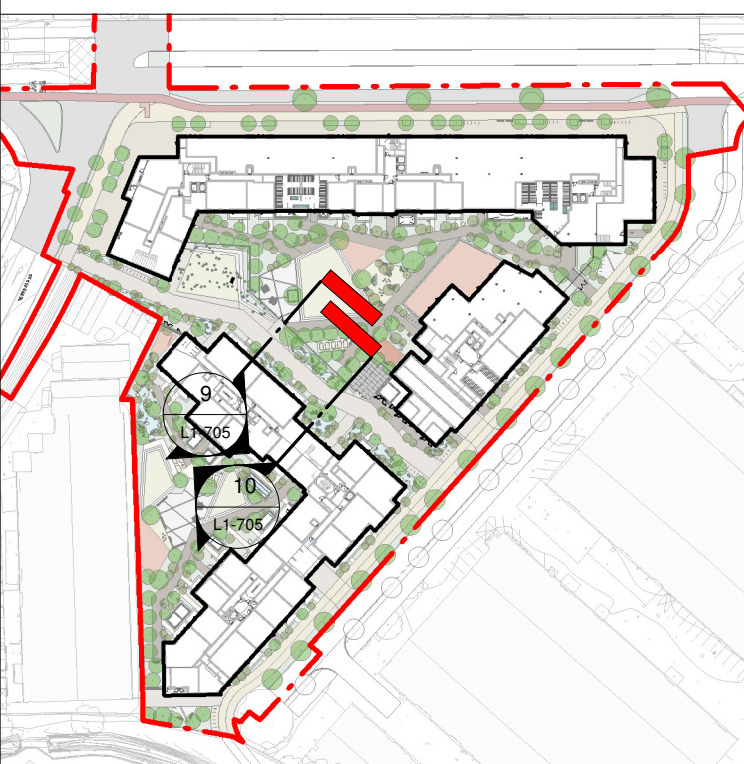

REVISIONS

Job No.	28A5A	Drawn By	RK
Dwg No.	L1-705	Checked By	JM
Scale	As indicated @A1	Date	MARCH 2025

JOB DESCRIPTION

Site	PARKMORE, LONG MILE ROAD, DUBLIN
Project	PARKMORE
Title	SECTIONS AND ELEVATIONS 5 OF 6



**NMP**  
Niall Montgomery + Partners

Architects 33 Rock Road, Williamstown, Blackrock, Co. Dublin  
Telephones : 2121 800 Fax : 2121 007 E mail : info@nmp.ie